

# Self Serve Heated Merchandiser

## Island Zone 6

*The large capacity 6 foot Island Zone is ideal for merchandising pre-packaged hot foods and increasing impulse sales in the deli or anywhere else in the store.*

### Features

**Easy to use controls :** One on/off switch activates the heat and the lights.

**Surface mounted temperature strips :** Confirm when the unit is warmed up and ready to safely accept food.

**Unique zone technology :** Thermostats in 24 independently controlled zones automatically adjust heat to ensure food temperature is consistently maintained above the food safety danger zone without overcooking or operator intervention.

**Large capacity :** Over 23 square feet of heated shelf space. Easily accommodates up to 40 whole chickens in domes without stacking.

**Superior illumination :** Teflon coated incandescent bulbs illuminate food and backlight attractive, visible, easy to change signage.

**All stainless steel construction** of the holding cavity makes for easy cleaning.

**Bumpers :** Durable black or red bumpers protect merchandiser.

**Heat shield :** Lexan heat shield/product stop on top shelf for safe operation.

**Product stops** Attractive smoked acrylic product stops on the lower level.

**Warranty :** 2 year parts and labor.



### Options

- Custom colored bumpers
- Custom colored or stainless steel base
- Casters
- Custom back lit signs



**The Food Systems Resource**  
**Hardt Equipment Manufacturing**

1756 50<sup>th</sup> Avenue, Lachine, Quebec, Canada H8T 2V5

**Tel.:** (888) 848.4408 (514) 631.7271

**Fax:** (514) 631.7273 **Web:** www.hardtequipment.com

# Self Serve Heated Merchandiser

## Island Zone 6

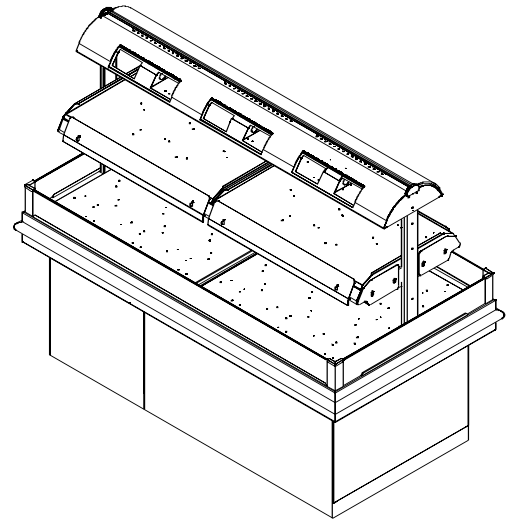
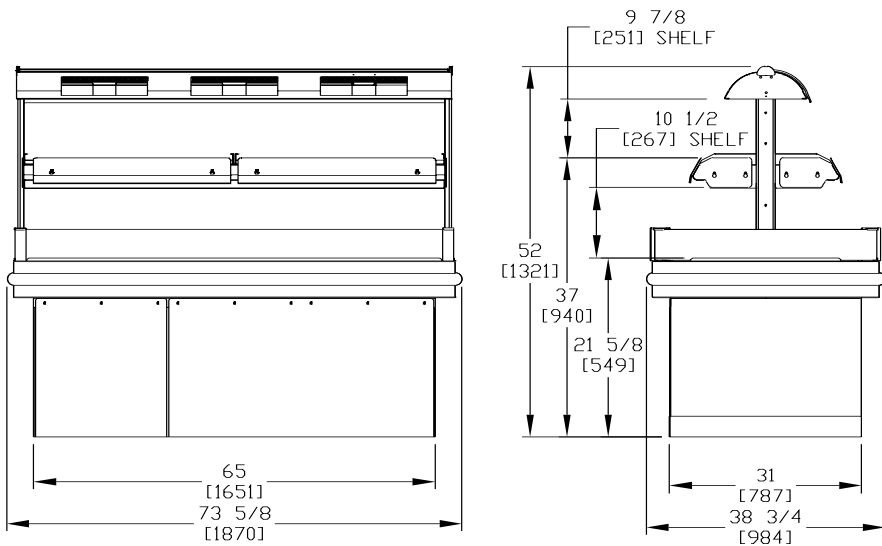

**NOTE:**

- 1) CAPACITY: 40 CHICKEN DOMES OR EQUIVALENT
- 2) SHIPPING WEIGHT: APPROX. 850 LBS
- 3) ELECTRICAL SUPPLY MAY BE EITHER 208/120VAC OR 240/120VAC (SEE TABLE) HAVING A SINGLE PHASE, 50/60 HZ, 4-WIRE SUPPLY (2-HOT, 1-NEUTRAL, 1-GROUND) EQUIPPED WITH A 2POLE CIRCUIT BREAKER.
- 4) UPPER LEVEL CONTAINS 12 BULBS AND 6 HEATED ZONES; LOWER LEVEL CONTAINS 16 BULBS AND 18 HEATED ZONES.
- 5) 150W BULBS MAY ONLY BE USED ON THE UPPER LEVEL.
- 6) WHEN THE OPTION OF CASTERS IS TAKEN, THE UNIT HEIGHT INCREASES BY 3"

SUPPLY VOLTAGE	CONFIGURATION	PEAK POWER CONSUMPTION	RECOMMENDED BREAKER PER POLE
208/120 VAC	ALL 100 WATT LAMPS	5107 WATTS	30 AMPS
	100W & 150W LAMPS	5707 WATTS	35 AMPS
240/120 VAC	ALL 100 WATT LAMPS	5872 WATTS	35 AMPS
	100W & 150W LAMPS	6472 WATTS	35 AMPS

TAKEN FROM 99-3960-E  
DATE: 17 MAY 07

### Warranty

HARDT warrants its products to be free from defects in materials and workmanship under normal use and service for a period of two ( 2 ) years, either from the original installation date or 8 weeks after the display is shipped, whichever comes first. This warranty is applicable to the original end user and is not transferable.

*Hardt improves its products continuously and reserves the right to change specifications without notice ©HARDT 2007*



Tel.: (888) 848.4408 (514) 631.7271 Fax: (514) 631.7273  
Web: [www.hardtequipment.com](http://www.hardtequipment.com)